



# Redistricting Phase 2

---

April 25, 2022

RCW  
29A.76.010

Counties, municipal corporations, and special purpose districts are to periodically redistrict its governmental unit based upon population information from the most recent federal decennial census.

# ASD Redistricting Timeline

---

- Sammamish Data Solutions (SDS) reviews current boundaries
- 2020 Census into current districts
- Determination and recommendation regarding redistricting

**STAGE 1**

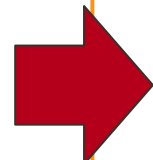

- School Board responds to recommendation
- Board to provide direction to SDS
- Redistrict current boundaries (April 25)

**STAGE 2**

- School Board approves redistricting plan (May 9)
- Finalization of legal descriptions and maps

**STAGE 3**

# Redistricting Criteria

*Applied in the order shown.*

- Nearly equal in population as possible
- Be as compact as possible
- Consist of geographically contiguous area
- Population data may not be used for purposes of favoring or disfavoring any racial group or political party
- To the extent feasible and if not inconsistent with the basic enabling legislation...district boundaries shall coincide with existing recognized natural boundaries and shall, to the extent possible, preserve existing communities of related and mutual interest
- Other criteria the Board would like to be considered

# Overall Director Districts

Comparison of 2010  
Census Data and 2020  
Census Data

	<b>2010</b>	<b>2020</b>
Population	84,053	102,021
White	59,629	53,777
Black/African American	3,674	7,102
American Indian & Alaska Native	2,672	3,295
Asian	6,910	12,367
Native Hawaiian and Other Pacific Islander	1,326	3,069
Other Race	5,313	10,515
Two or More Races	4,529	11,896
Hispanic Origin	10,744	18,823
Non-White & Mixed	24,424	48,244

# Redistricting Recommendations

---

by Sammamish Data Solutions





# Director District #1

Director District #1		
	2010	2020
Population*	22,404	20,384
White	11,467	10,192
Black/African American	1,696	1,535
American Indian & Alaska Native	343	307
Asian	3,509	3,401
Native Hawaiian and Other Pacific Islander	740	668
Other Race	2,133	1,974
Two or More Races	2,516	2,307
Hispanic Origin	3,743	3,475
Non-White & Mixed	10,937	10,192

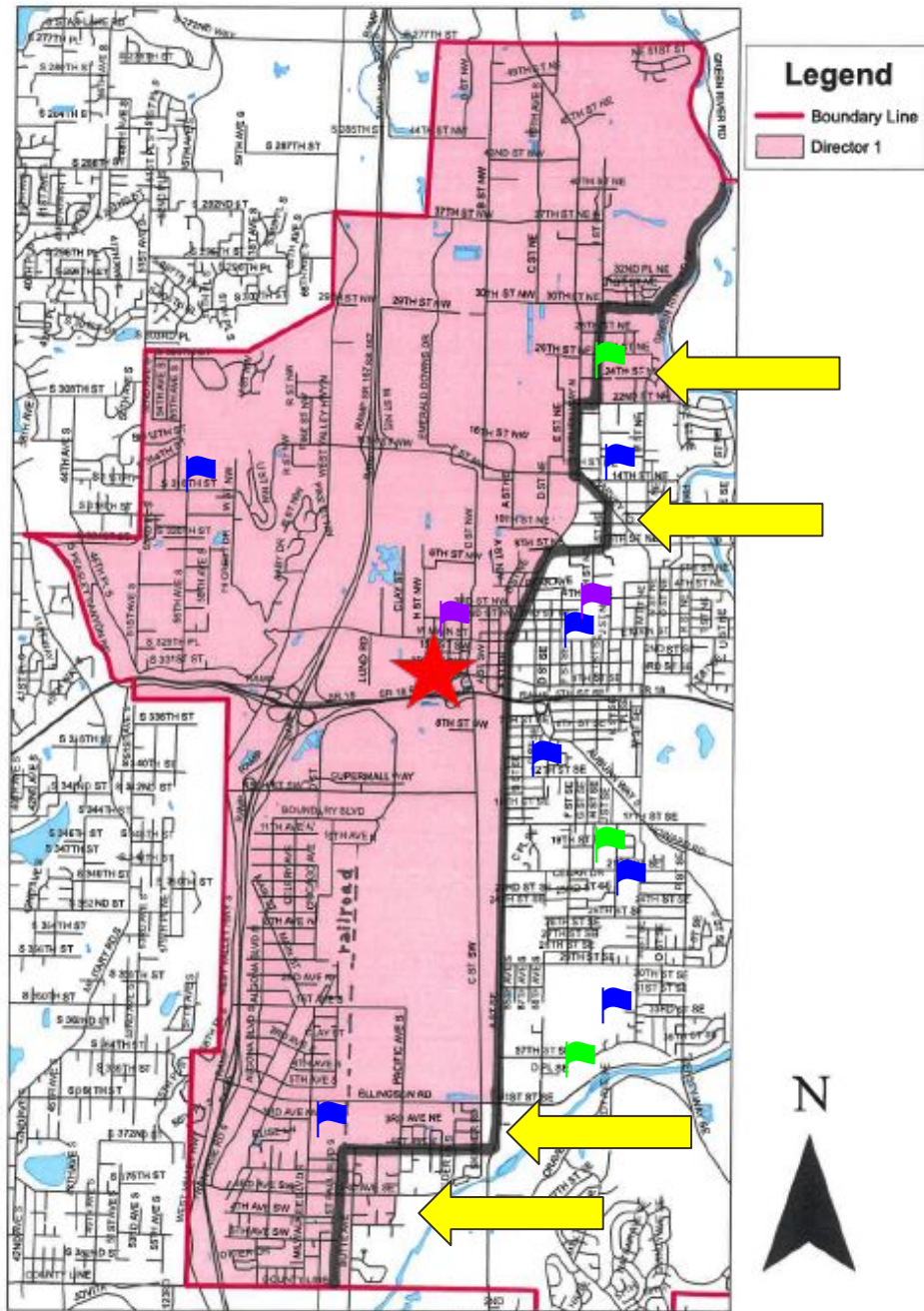
*\*Ideal population for 2020 is 20,404*

# Auburn School District # 408 - Director District 1



-  = suggested district boundary
-  Elementary Schools
-  Middle Schools
-  High Schools
-  Director Home Address



Recommended  
Revised  
Director  
District #1

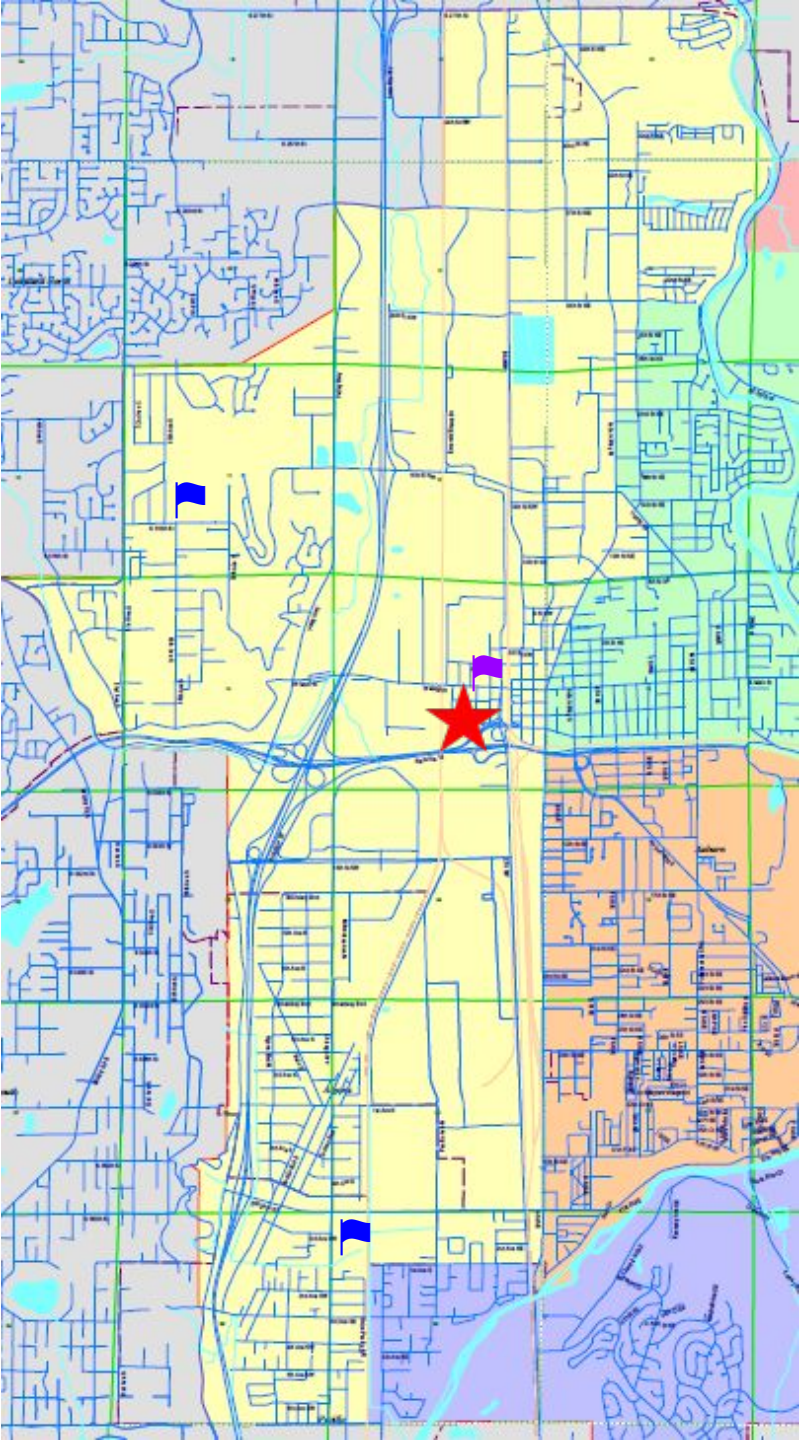

# Director District #2

Director District #2		
	2010	2020
Population*	18,577	20,396
White	10,438	11,646
Black/African American	1,324	1,458
American Indian & Alaska Native	270	303
Asian	1,776	1,896
Native Hawaiian and Other Pacific Islander	657	712
Other Race	1,953	2,043
Two or More Races	2,159	2,338
Hispanic Origin	3,528	3,694
Non-White & Mixed	8,139	8,750

*\*Ideal population for 2020 is 20,404*

# Auburn School District # 408 – Director District 2

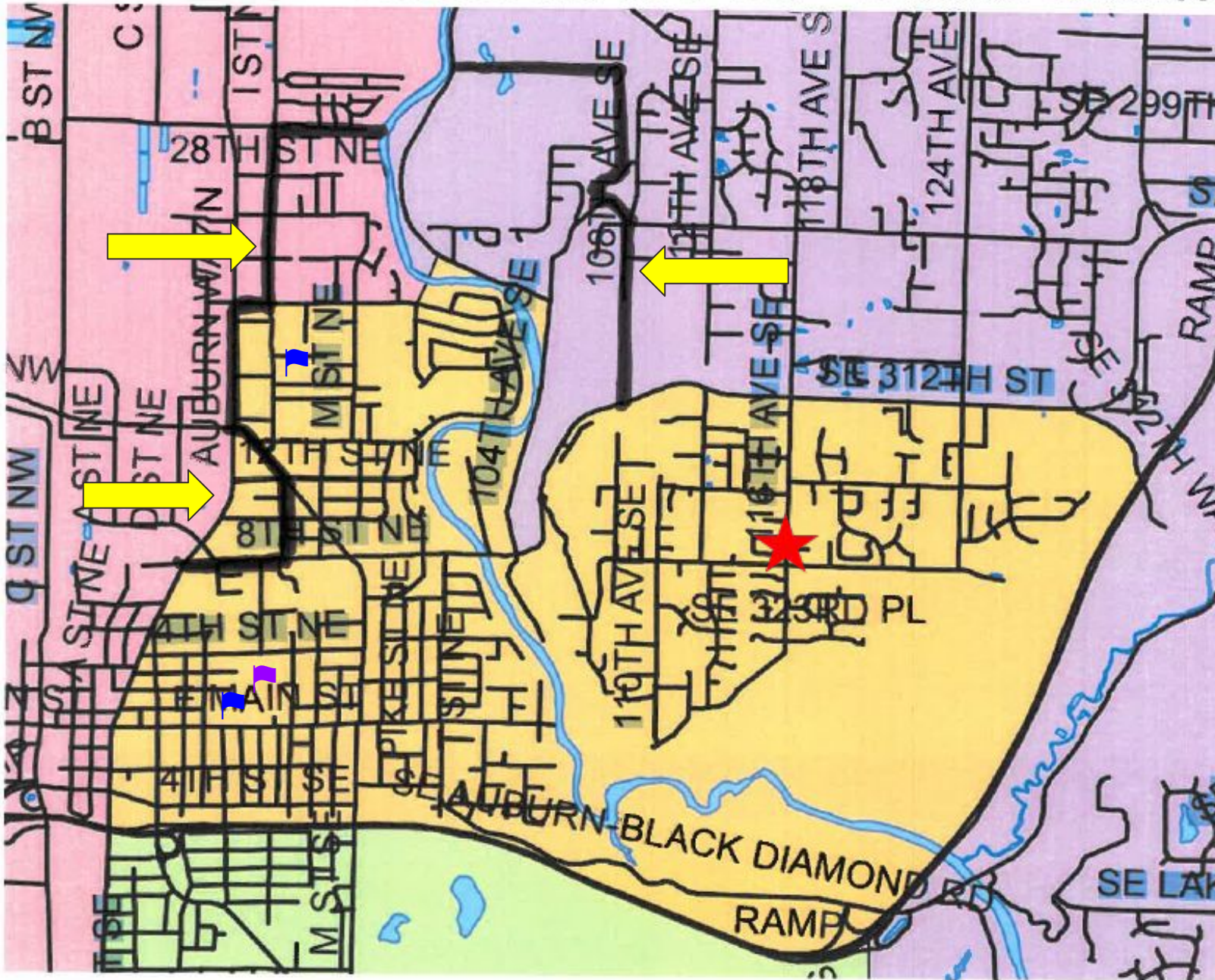

**Legend**

- Boundary Line
- Director 2

- = suggested district boundary
- Elementary Schools
- Middle Schools
- High Schools
- Director Home Address



# Recommended Revised Director District #2

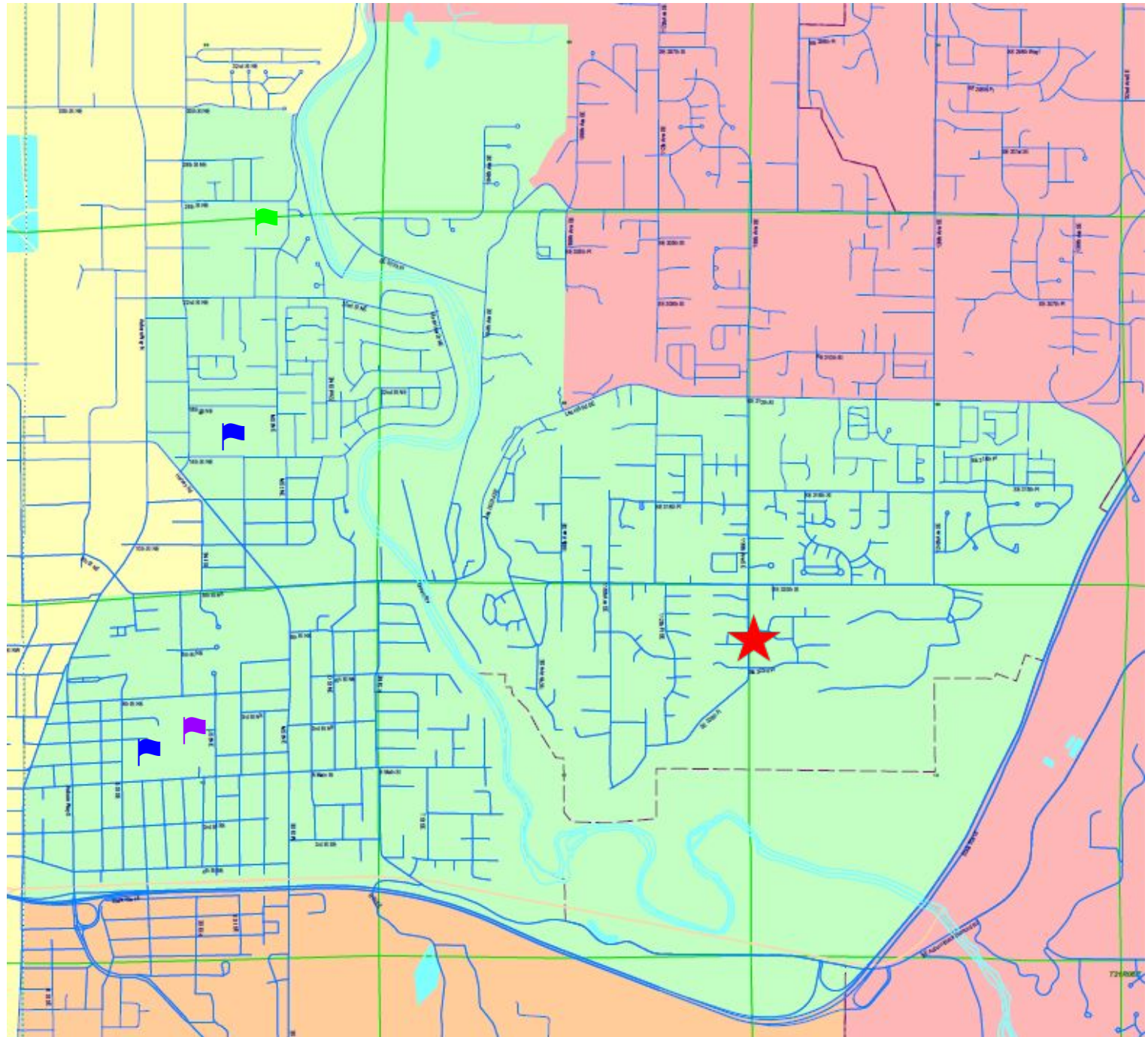

# Director District #3

Director District #3		
	2010	2020
Population*	19,267	20,423
White	8,850	9,177
Black/African American	1,444	1,481
American Indian & Alaska Native	868	836
Asian	1,277	1,248
Native Hawaiian and Other Pacific Islander	1,006	953
Other Race	3,290	4,033
Two or More Races	2,532	2,695
Hispanic Origin	5,607	6,625
Non-White & Mixed	10,417	11,246

*\*Ideal population for 2020 is 20,404*

# Auburn School District # 408 – Director District 3

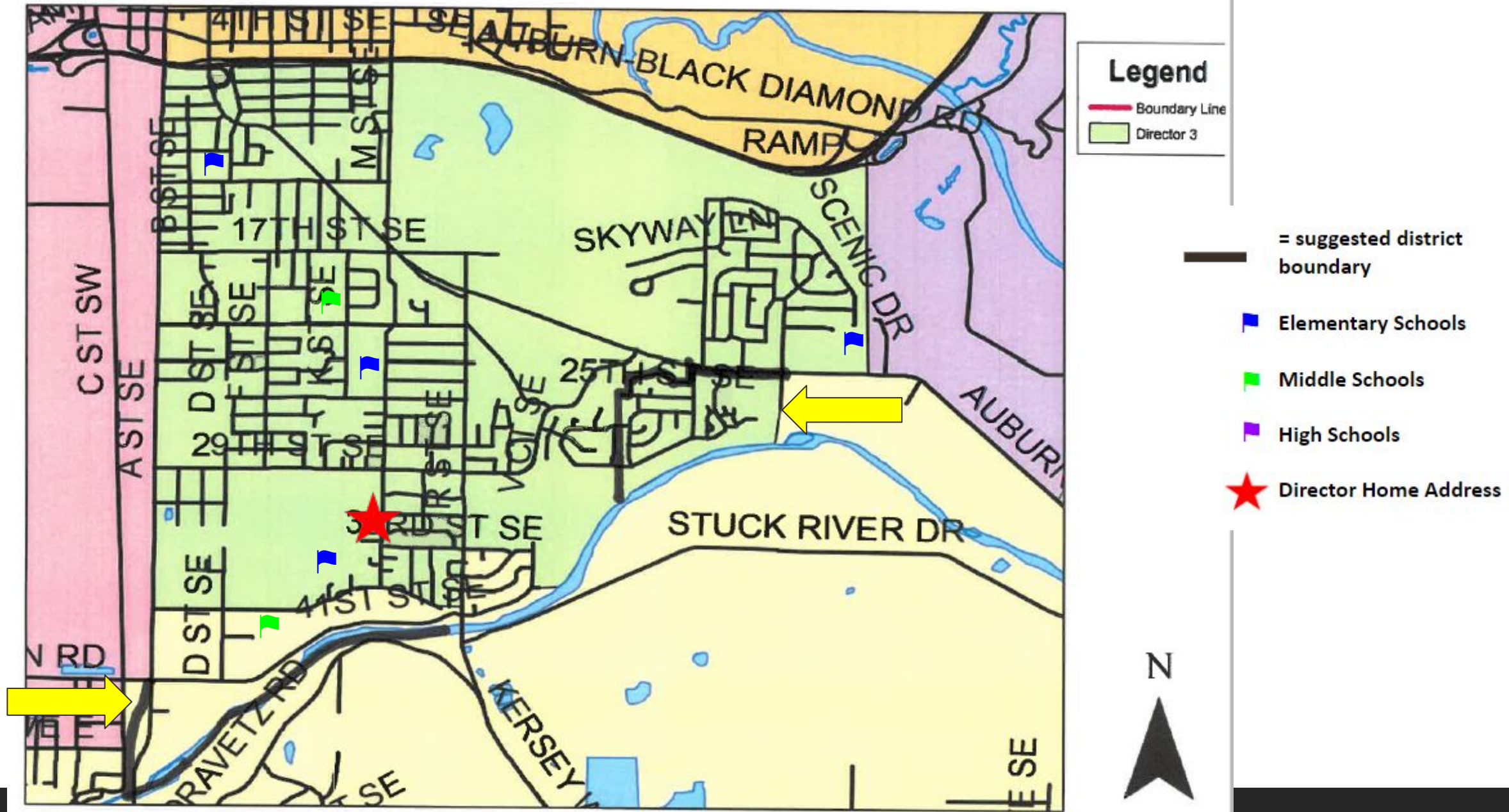

# Recommended Revised Director District #3

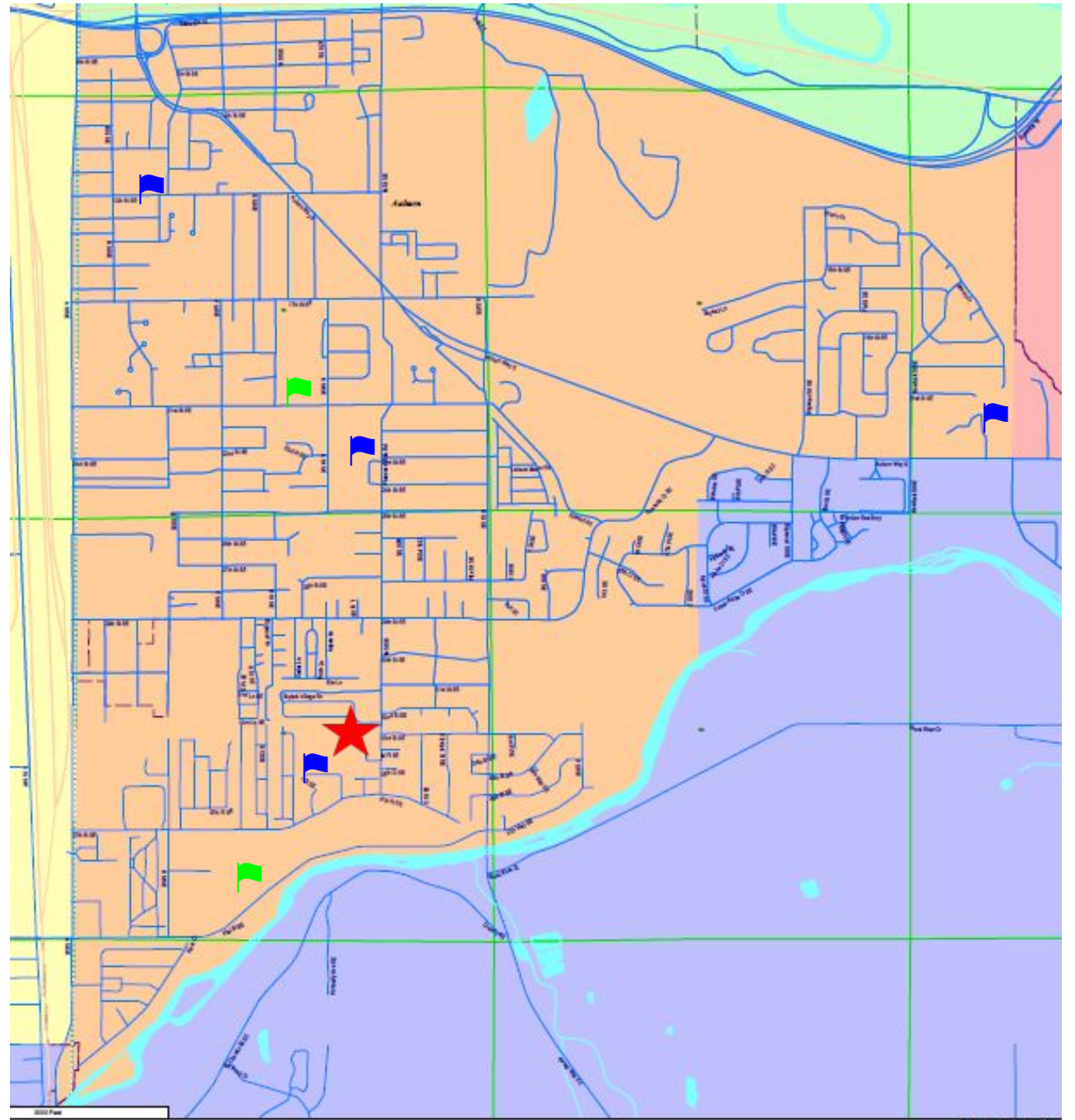

# Director District #4

Director District #4		
	2010	2020
Population*	20,726	20,416
White	10,759	10,956
Black/African American	1,107	1,110
American Indian & Alaska Native	1,538	1,588
Asian	2,586	2,674
Native Hawaiian and Other Pacific Islander	320	391
Other Race	1,830	1,174
Two or More Races	2,586	2,523
Hispanic Origin	3,524	2,669
Non-White & Mixed	9,967	9,460





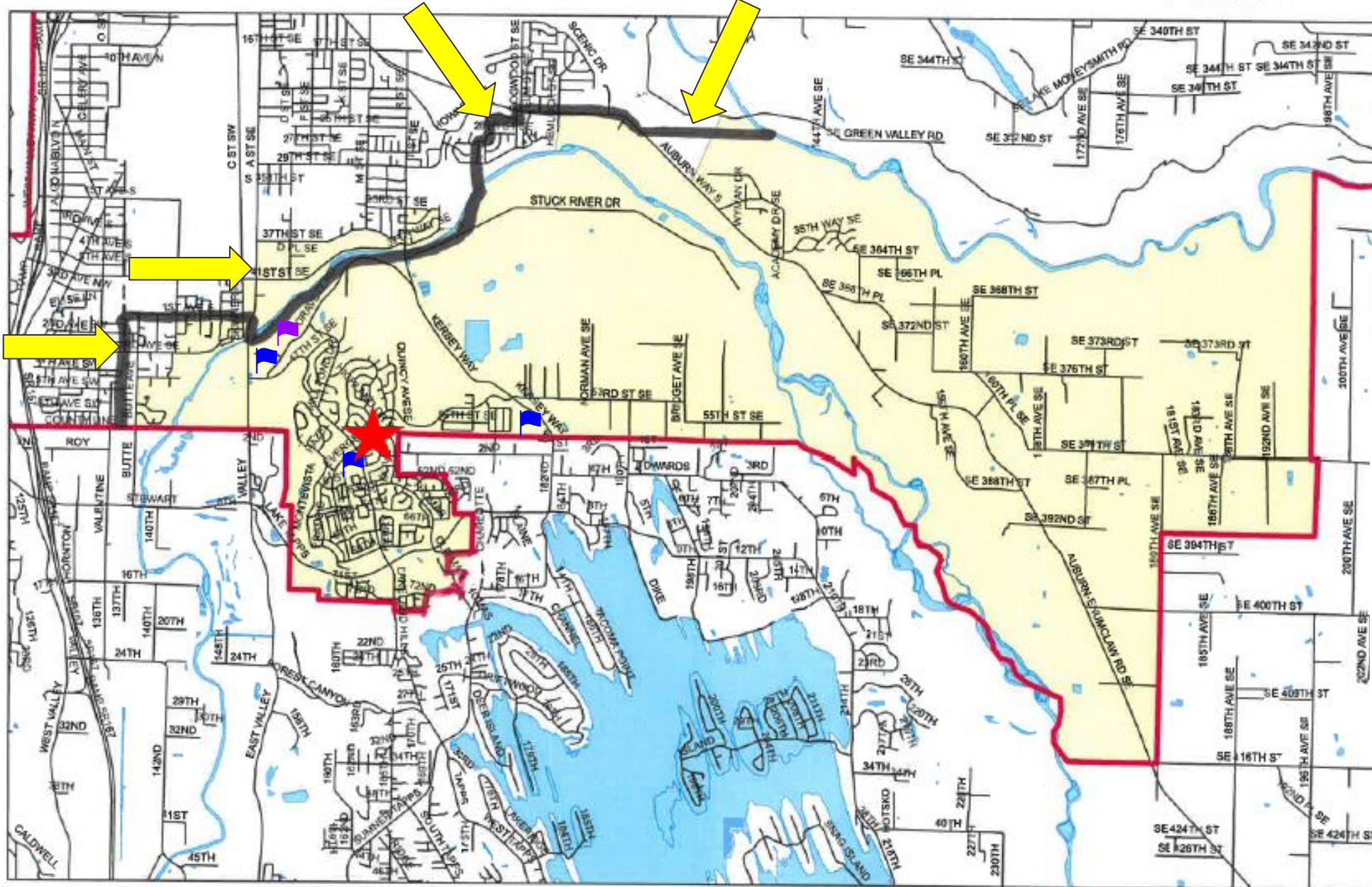

*\*Ideal population for 2020 is 20,404*



# Auburn School District # 408 - Director District 4



### Legend

-  Boundary Line
-  Director 4
-  = suggested district boundary
-  Elementary Schools
-  Middle Schools
-  High Schools
-  Director Home Address

N



Recommended  
Revised  
Director  
District #4

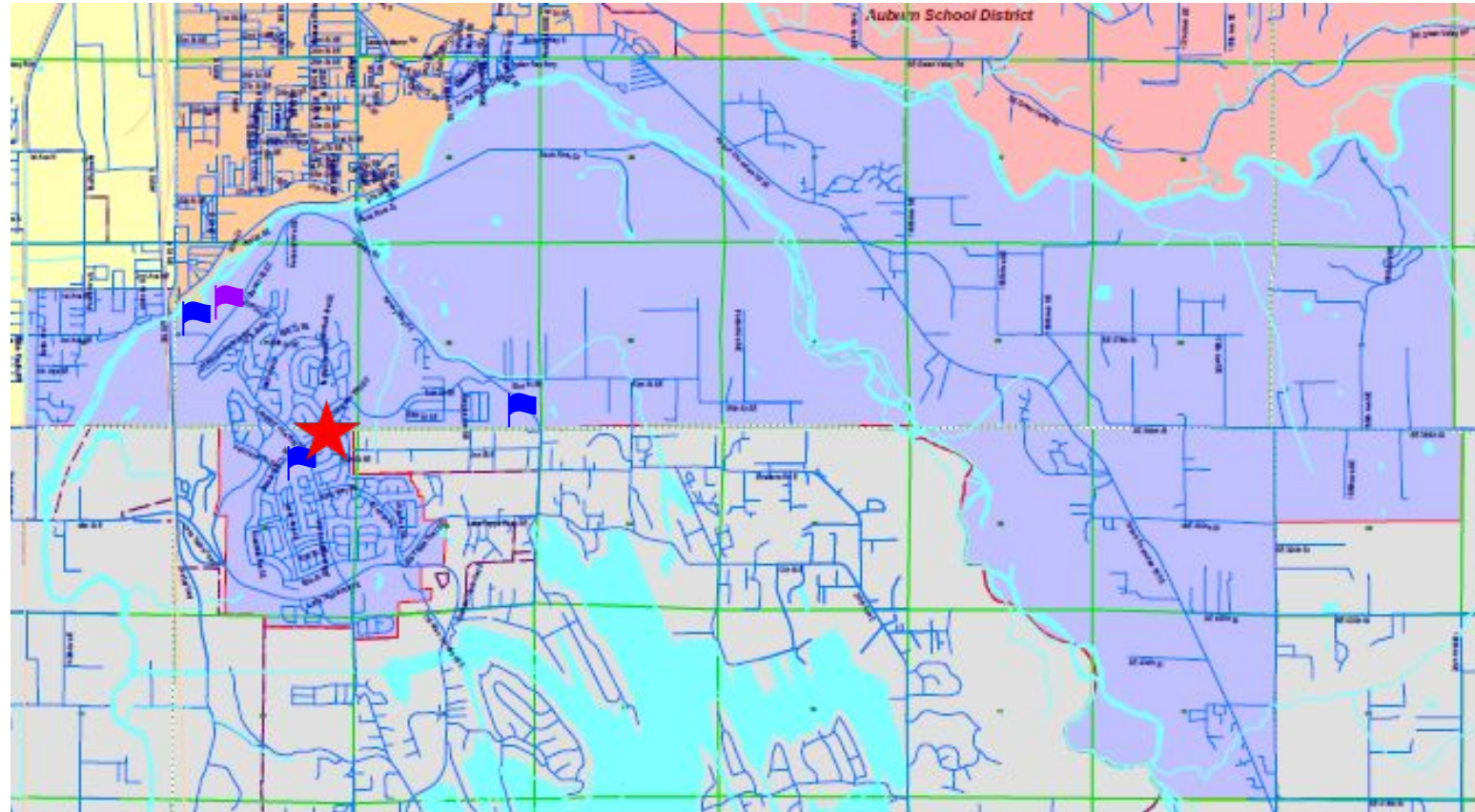

# Director District #5

Director District #5		
	2010	2020
Population*	21,047	20,402
White	12,263	11,806
Black/African American	1,531	1,518
American Indian & Alaska Native	276	261
Asian	3,219	3,148
Native Hawaiian and Other Pacific Islander	346	345
Other Race	1,309	1,291
Two or More Races	2,103	2,033
Hispanic Origin	2,421	2,360
Non-White & Mixed	8,784	8,596

*\*Ideal population for 2020 is 20,404*

# Auburn School District # 408 - Director District 5

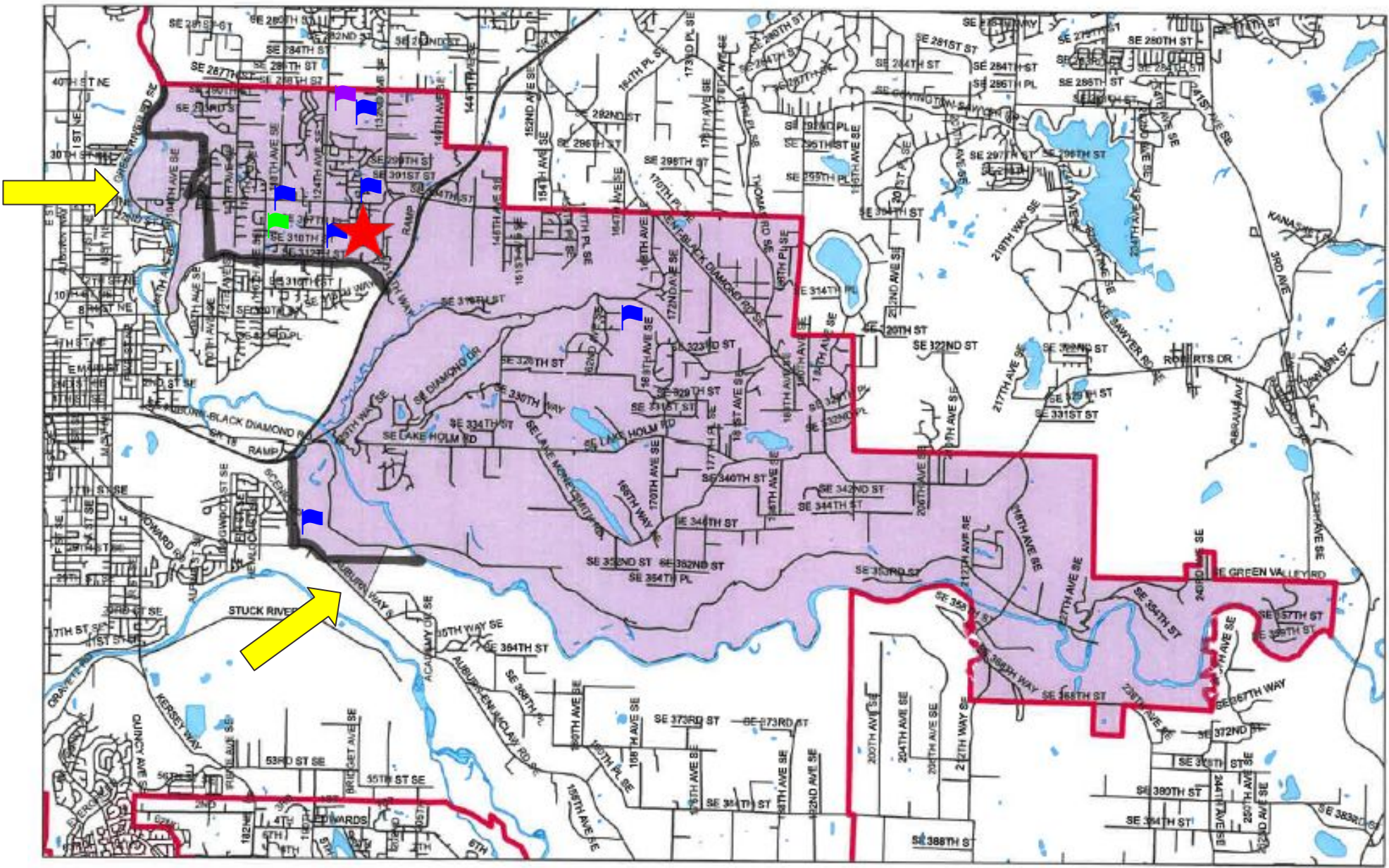

**Legend**

- Boundary Line
- Director 5

- isted district
- ry
- itary Schools
- Schools
- hools
- r Home Address



# Recommended Revised Director District #5

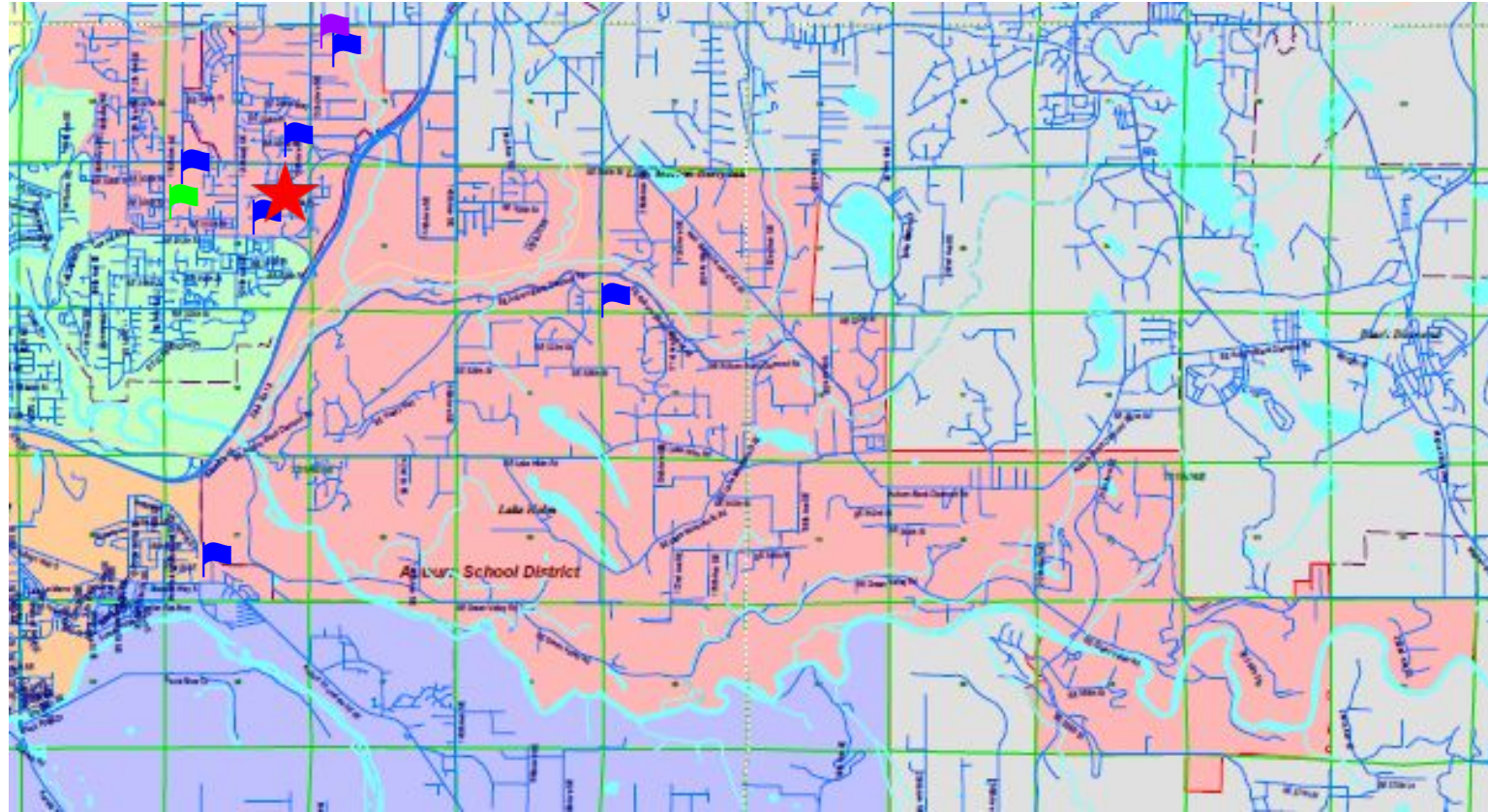

# Recommended Revised ASD Director Districts

<b>DIRECTOR DISTRICT</b>	<b>TOTAL POPULATION*</b>	<b>WHITE</b>	<b>BLACK AFRICAN AMERICAN</b>	<b>AMERICAN INDIAN ALASKA NATIVE</b>	<b>ASIAN</b>	<b>NATIVE HAWAIIAN AND OTHER PACIFIC ISLANDER</b>	<b>OTHER</b>	<b>TWO OR MORE RACES</b>	<b>HISPANIC ORIGIN (of any race)</b>
<b>1</b>	20,384	10,192	1,535	307	3,401	668	1,974	2,307	3,475
<b>2</b>	20,396	11,646	1,458	303	1,896	712	2,043	2,338	3,694
<b>3</b>	20,423	9,177	1,481	836	1,248	953	4,033	2,695	6,625
<b>4</b>	20,416	10,956	1,110	1,588	2,674	391	1,174	2,523	2,669
<b>5</b>	20,402	11,806	1,518	261	3,148	345	1,291	2,033	2,360

\*Ideal population for 2020 is 20,404

# Recommended Revised ASD Director Districts

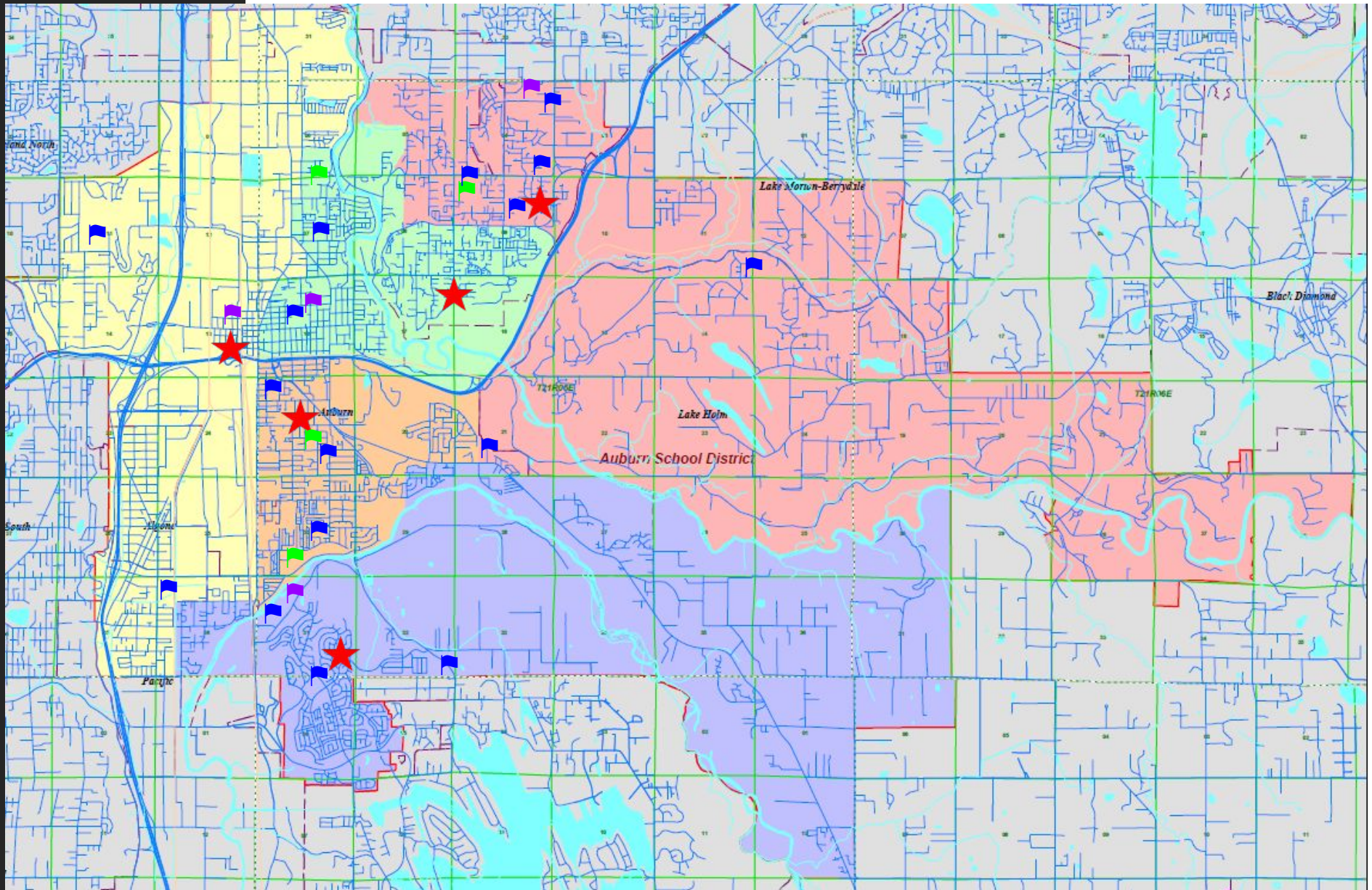

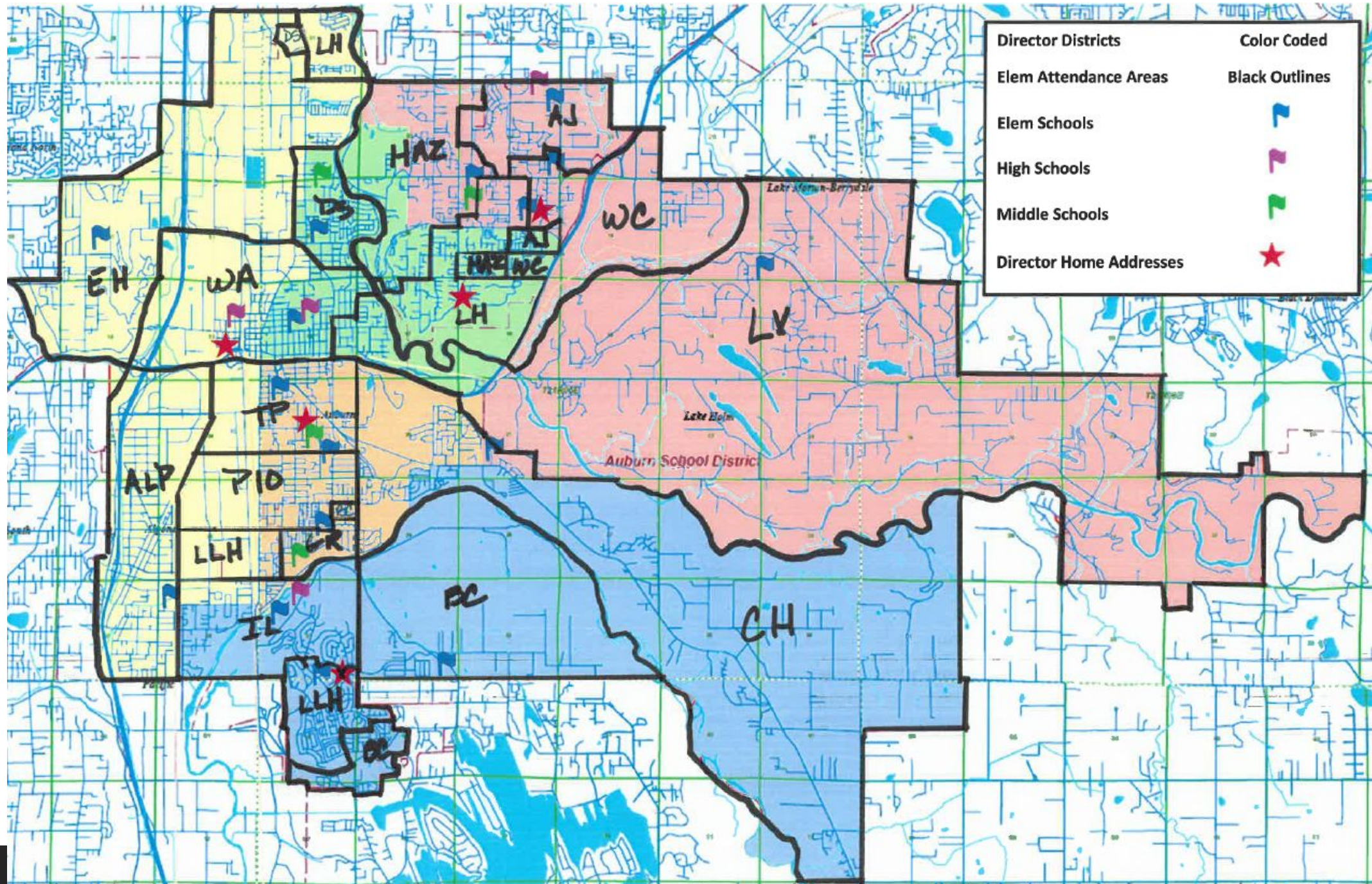



# ASD Redistricting Timeline

---

- Sammamish Data Solutions (SDS) reviews current boundaries
- 2020 Census into current districts
- Determination and recommendation regarding redistricting

**STAGE 1**

- School Board responds to recommendation
- Board to provide direction to SDS
- Redistrict current boundaries

**STAGE 2**

- School Board approves redistricting plan (May 9)
- Finalization of legal descriptions and maps

**STAGE 3**



# Auburn School District

## Redistricting Webpage



915 4th Street NE  
Auburn, WA 98002  
p: (253) 931-4900  
f: (253) 931-8006

-  ASD Home
-  Child Nutrition
-  Contact Us
-  Google Drive
-  OWA Email
-  Calendar
-  Family Access

- Home
- Our District
- For Families
- For Staff
- Departments
- Community

### SCHOOL BOARD

- ▶ About Auburn School Board
- ✦ School Board Members and Director Districts
- ▶ Board Agendas and Minutes
- ▶ School Board Protocol
- ▶ School Board Protocol - Spanish
- ▶ School Board Policies
- ✦ Strategic Plan 2017-2022
- ▶ 2016 Educational Program and Operations Replacement Levy
- ✦ February 2020 Election
- ✦ 2020 Citizen's Ad Hoc Attendance Area Committee
- ▶ Strategic Plan 2022-2027
- ▶ Auburn Redistricting

Auburn School District > Our District > School Board Auburn Redistricting



[Auburn School Director Redistricting Presentation](#)

[Director District #1 Current Map](#)

[Director District #1 Recommended Map](#)

[Director District #2 Current Map](#)

# Questions?

---